

OREGON PUBLIC LAND CORNER REPORT / RESTORATION REPORT
Tillamook County Surveyor's Office

SECTION: 13, 18, 24 and 19	TOWNSHIP: 2 South	RANGE: 9 and 10 West
COUNTY: Tillamook		DATE: 02/22/2023
CORNER DESIGNATION: Section corner common to sections 13 and 24, Township 2 South, Range 10 West, and Sections 18 and 19, Township 2 South, Range 9 West; Willamette Meridian.		(Please check one)
		<input type="checkbox"/> Condition Report Only
		<input type="checkbox"/> Restoration
		<input checked="" type="checkbox"/> Rewitness
		<input type="checkbox"/> Unrecorded
		<input type="checkbox"/> Reset at surface
		<input type="checkbox"/> Referenced Out

Previous Rewitnesses, Restorations and Surveys, etc...

S3 pg. 278 (1899), Field Bk. P16 pg. 60 (1915), F-19-25 (1915), F-40-281 (1915), B-156 (1949), Rewitness Bk. 1 pg. 95 (1951), B-317 (±1954), F-2-11 (1962), B-472 (1963), Rewitness Bk. 5 pg. 218 (1972), B-644 (1973), B-688 (1974), B-922 (1980), B-923 (1980), B-961 (1981), A-5783 (1989), A-6078 (1990), B-1429 (1990), Rewitness Bk. 6 pg. 461 (1990), P-112 (1992), A-6821 (1994), Field Bk. MR 14 pg. 41 (2023)

History, condition, and sources: Under G.L.O. contract # 67 corner post was set and 4 bearing trees were established. In 1915 corner was reestablished by Reitze, Storey and Duffy engineers on Tillamook County Surveyors map (F-19-25). In 1949 Robert Walker reestablished corner on T.C.S.M. (B-156). In 1954 W.E. Anderson, Tillamook County Surveyor deemed corner incorrect on T.C.S.M. (B-317). He set a 2" iron pipe with wood plug and nail. In 1951 bearing trees were established for the corner set by Robert Walker in Tillamook County Surveyors Rewitness Bk. 1 pg. 95 by W.E. Anderson and Francis L. Smith and retied as bearing trees to Andersons' corner in 1972 in Tillamook County Surveyors Rewitness Bk. 5 pg. 218. In 1990 Tillamook County Surveyors set a 1 1/2" iron pipe with a 3" Dia. Tillamook County Surveyors Brass Cap in a 10" concrete cylinder 18" deep from ties made on T.C.S.M.(B-1429). In 2023 (Field Bk. MR 14 pg.41), Tillamook County Survey Office visited the corner and found a 3" Tillamook County Brass Cap in concrete marked "T2S R10W R9W S13 S18 S24 S19 1990" as shown hereon in good condition.

- Found: (Rewitness Bk. 6 pg. 461) 10" Spruce, now 66" (S. 43° 58' 37" W. 77.08')
- Found: (Rewitness Bk. 6 pg. 461) 40" Spruce, now 66" (N. 8° 40' W. 182.66')
- Found: (Rewitness Bk. 6 pg. 461) Twin Spruce, now rotten remains (S. 62° 28' E. 157.4')
- Found: (Rewitness Bk. 6 pg. 461) 2 1/2" O.D. iron pipe (Walkers position) (S. 13° 57' 23" E. 38.33')

New accessories set:

- Set: 72" hat section post with yellow metal location tag West 2.3'
- Set: yellow metal location tag on 66" Spruce
- Set: yellow metal location tag on 66" Spruce

The Monument was tied directly using G.P.S. established control. The coordinates have been converted and are provided here in WGS 84, Latitude and Longitude.

Latitude: 45° 23' 26.84"
Longitude: 123° 50' 43.00"

Pictures of Found Monuments:



Location: Take Bewley Creek Road for ±1.5 miles to private drive south of Bewley Creek Road. ±500' on private drive to a farm lane. Then Southwest on farm lane for ±1800' to open pasture. Monument is ±200' West of a farm lane and ±600' Southeast of Bewley Creek Road.

Tillamook County Surveyor office: 1510 3rd Street Suite C, Tillamook, OR. 97141

Party Chief: Travis Porter, Survey Supervisor

Witnesses: Michael Rice, PLS 86926, Tillamook County Surveyor
Kael Poklikuha, Survey Technician

Notes: Digital images taken of monument and accessories.

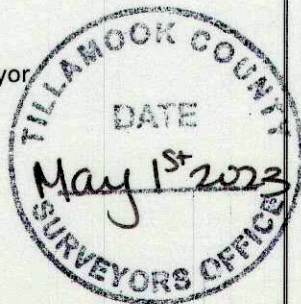

SURVEYOR'S SEAL

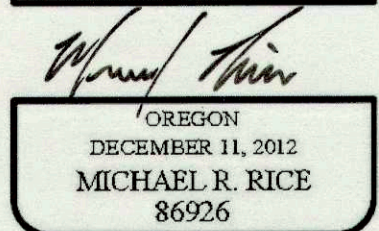
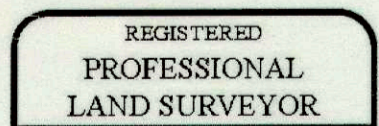

RENEWAL 12-31-2024